

**Material:**

**Housing:** 30% Glass filled PBT UL94V-0.  
**Contacts:** Phosphor Bronze.  
**Plating:** Gold plated over nickel.  
 Tin plated over nickel.

**Electrical Characteristics:**

**Current Rating:** 1 AMP.  
**Insulator Resistance:** 5000MΩmin. at DC 500V.  
**Contact Resistance:** 20mΩmax. at DC 100mA.  
**Operating Temperature:** -55°C ~ +105°C.

**Mechanical Characteristics:**

**Insertion Force:** 140g avg.(0.64mm sq. pin)  
**Withdrawal Force:** 114g avg.(0.64mm sq. pin)

**Features:**

- \* Wide range of board spacing choices.
- \* Strong and great product flexibility.
- \* Turning fork contacts offer lower cost for competitive market.

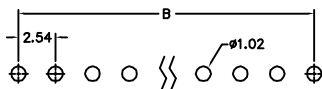
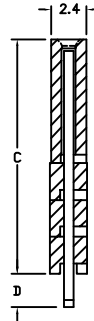
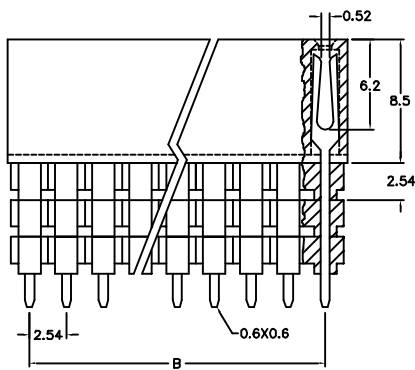
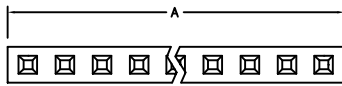

P.C. Board Layout

Position	3 Thru 40							
Dimension								
A	2.54 X No. of Positions +0.5							
B	2.54 X No. of Positions -2.54							
C	L1	L2	L3	L4	L5	L6	L7	L8
	11.05	11.05	13.59	16.13	11.05	13.59	16.13	18.67
D	2.50	7.35	4.85	2.30	12.2	9.65	7.10	4.60

**Ordering information**

PS08- 1 40 1 1 L1  
 Series Single Row No. of Pin Per Row 1: Gold Plated 2: Tin Plated 1: Straight Choices of L1 ~ L8